

Box Contents and Directions

- (A) - Perpetual Well Base
- (B) - Grommet
- (C) - Bowl
- (D) - Filter Assembly
- (E) - Float
- (F) - Lid
- (G) - Shut Off Tee $\frac{1}{2}$ "X $\frac{1}{4}$ "
- (H) - "P" Trap
- (I) - Disposer Tailpipe 1.5"
- (J) - Final Trap Adapter 1.5"
- (K) - PVC Tee 2" x 1.5"
- (L) - Tubing 3' of $\frac{1}{4}$ "
- (M) - Nut and Compression Ring $\frac{1}{4}$ "
- (N) - Wall Guard
- (O) - Screws [4] #6
- (P) - Rails

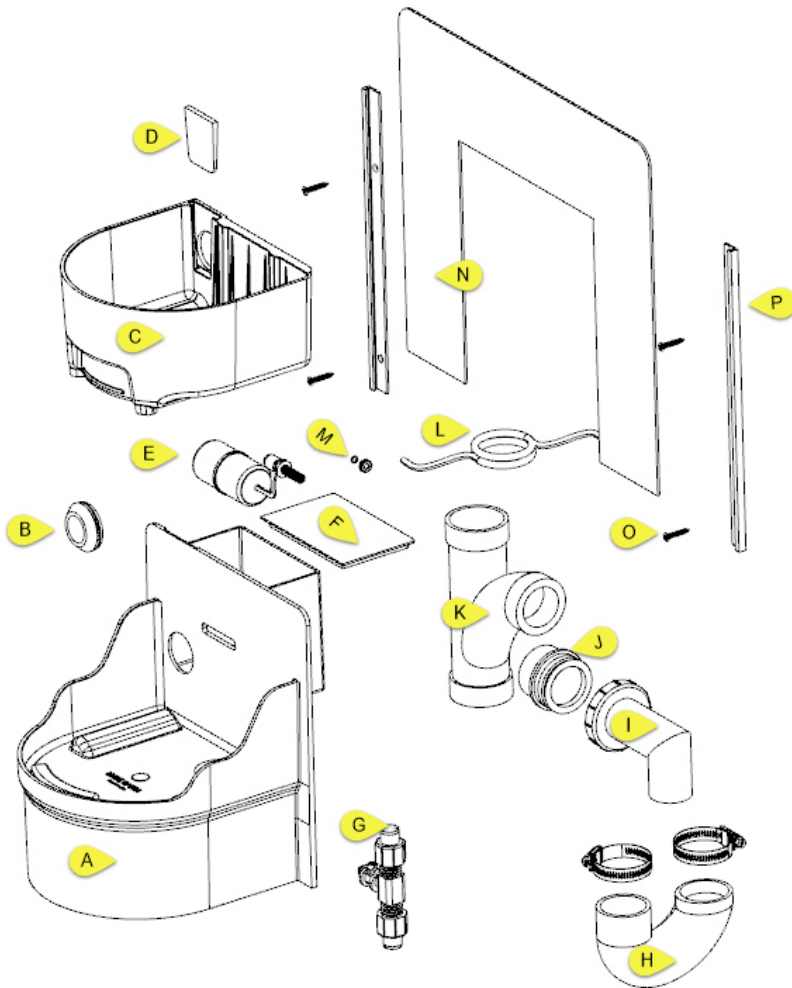

Wall Kit is used when installing PW onto a wall surface. Example: drywall, paneling, etc. (This requires a larger cut-out because plumbing will be done inside the wall stud pocket.) This kit contains all items listed in the chart above.

Perpetual Well recommends professional installation.

Installation Directions:

1. Select desired location for your Perpetual Well. PW can be installed anywhere there is basement or crawl space access to plumbing. For new construction Plumbing can be roughed in at time of build. Slab foundation remodel applications must be located near existing plumbing.

2. SHUT OFF WATER SUPPLY !

CONNECTING WATER SUPPLY:

3. Locate studs in wall application. Hole will be cut between studs. Make sure there is enough space for the (A)Base main reservoir to be pushed back into the wall. It is recommended to make a small hole first to be able to locate where PW will be installed and that there is no obstruction. Continue to cut the hole larger 13"X13".
4. Locate and cut cold water supply to insert compression (G)shut-off tee.
5. Slide (M)Nut and Compression Ring onto (L)tubing and insert tubing into (E)Float.
NOTE: Make sure to push tubing into float assembly at least a ¼" before tightening nut.

CONNECTING DRAIN LINE

6. Install (H) P-trap on the bottom of the Perpetual Well (A). Match the Numbers
7. Install (I) disposer tailpipe onto (H) P-trap.
8. Cut drain line to accommodate the (K) PVC Tee fitting. **NOTE: Tee FITTING MUST BE LOWER THAN LATERAL PIPE SO WATER FLOWS AWAY FROM PW.**
9. Attach (J) final trap adapter to the (K) PVC Tee fitting. **NOTE: A short section of pipe may need to be added depending on distance of pipe to Perpetual Well.**
10. Insert the PW into the cut hole. Insert Disposer Tailpipe into final trap adapter and tighten compression ring.

Box Contents and Directions

11. Make final connection of (L) ¼ " Tubing line from PW to the (G) shut-off Tee valve.
12. TURN ON WATER SUPPLY AND **CHECK FOR LEAKS AT ALL CONNECTIONS.**
13. When leak-free, turn ¼" supply off to finish installation.
14. Slide (N) wall guard into the slots in the back of the PW.
15. Place (P) rails onto the sides of the wallguard. Mark the wall with a pencil on the outer edge of the wall rails.
16. Remove rails and (N) wall guard. Measure 1/16" out from each marked rail line away from the bowl. Adding this small amount will allow the wall guard to slide freely for insertion and removal.
17. Place the wall rails onto the new lines and mark placement of the 4 holes with a pencil.
18. Mount (P) rails with (O) screws. Wall anchors (not Included) may be needed.
19. Insert the Perpetual Well (C) bowl ensuring that hole and (B) grommet are in alignment.
20. Install (D) filter and (F) Lid
21. Turn 1/4" water supply on. Slide Wall guard onto rails after checking for leaks.

Enjoy your Perpetual Well!